



# INSTALLATION INSTRUCTIONS

Accessory  
**REMOTE ENGINE START KIT**  
P/N 38015-TY2-A00

Application  
**2016 RLX**  
**(TECHNOLOGY PKG)**

Publications No.  
**VERSION 1**  
Issue Date  
**APR 2015**

**NOTE: For additional technical information,  
refer to the electronic service manual.**

## PARTS LIST

**Remote Engine Start Kit**  
**P/N 38015-TY2-A00**

Remote (2)

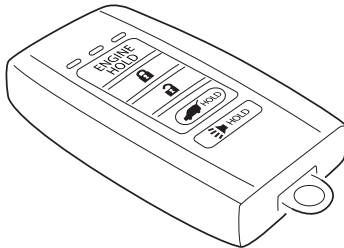

Bidirectional Antenna

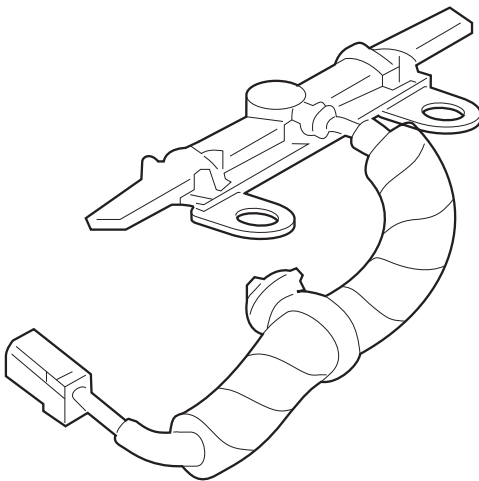

Transceiver

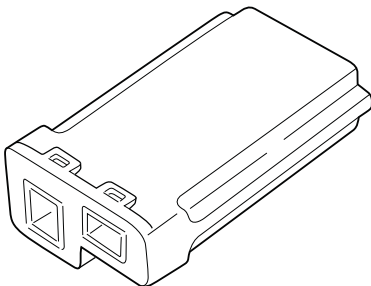

Antenna Bracket

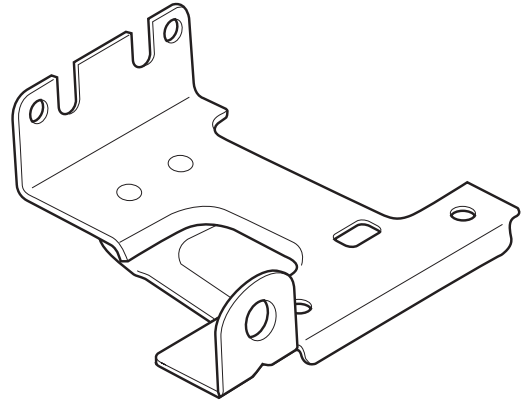

Screw (2)

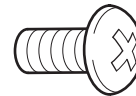

Self-Tapping Screw (2)

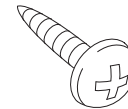

## TOOLS AND SUPPLIES REQUIRED

Phillips Screwdriver

8 mm Socket

Ratchet

*The following tools are available through the Honda Tool and Equipment Program. On the iN, click on: Service > Service Bay > Tool and Equipment Program, then enter the number under "Search". Or, call 888-424-6857.*

- Trim Tool Set (T/N SOJATP2014)
- Plastic Trim Tool (T/N SILTRIMTL10)

## INSTALLATION

**Client Information:** The information in this installation instruction is intended for use only by skilled technicians who have the proper tools, equipment, and training to correctly and safely add equipment to your vehicle. These procedures should not be attempted by “do-it-yourselfers.”

1. Disconnect the negative cable from the battery.
2. Place a clean shop towel over the shifter and center console. Remove the dashboard center lower panel and disconnect the connectors.

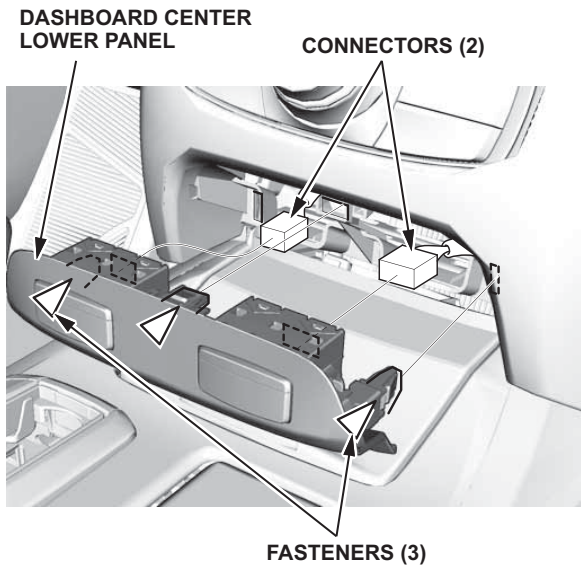

3. Remove the dashboard center panel and disconnect the connectors.

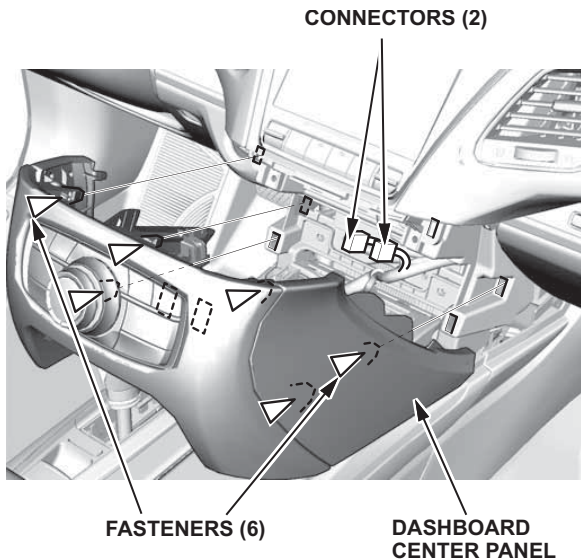

4. Remove the driver's inner dashboard trim and disconnect the connector.

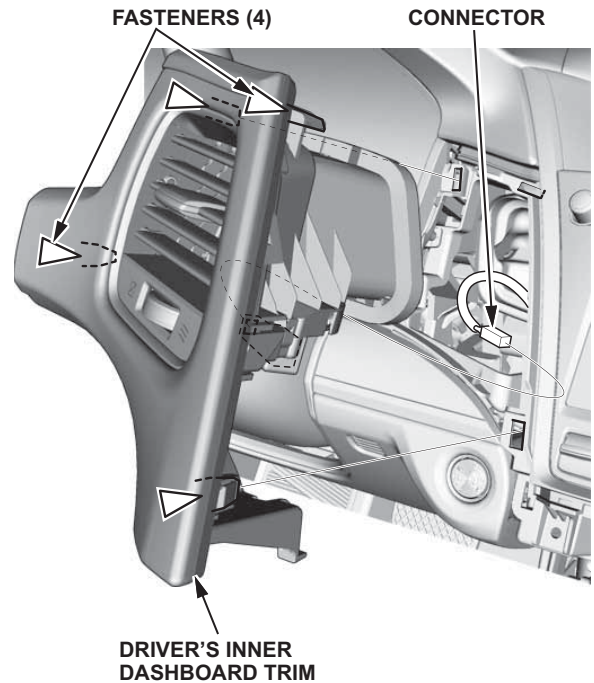

5. Remove the passenger's dashboard trim panel and disconnect the connector.

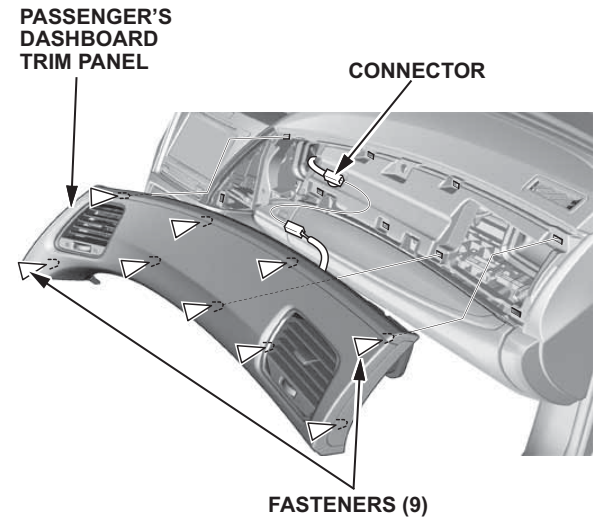

6. Attach tape to the areas shown on each side.

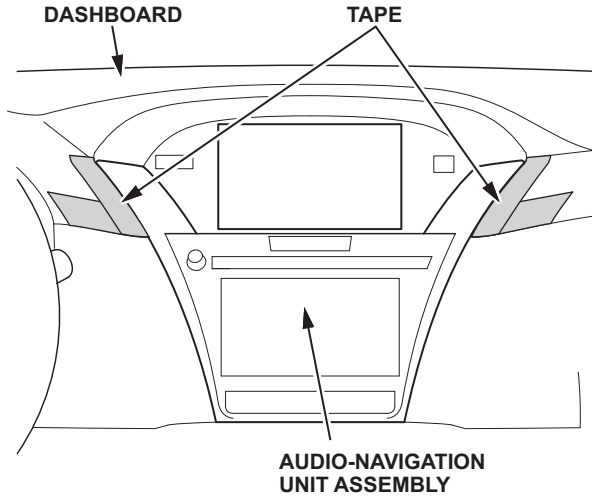

7. Pull out the audio-navigation unit assembly and disconnect the audio unit connectors.

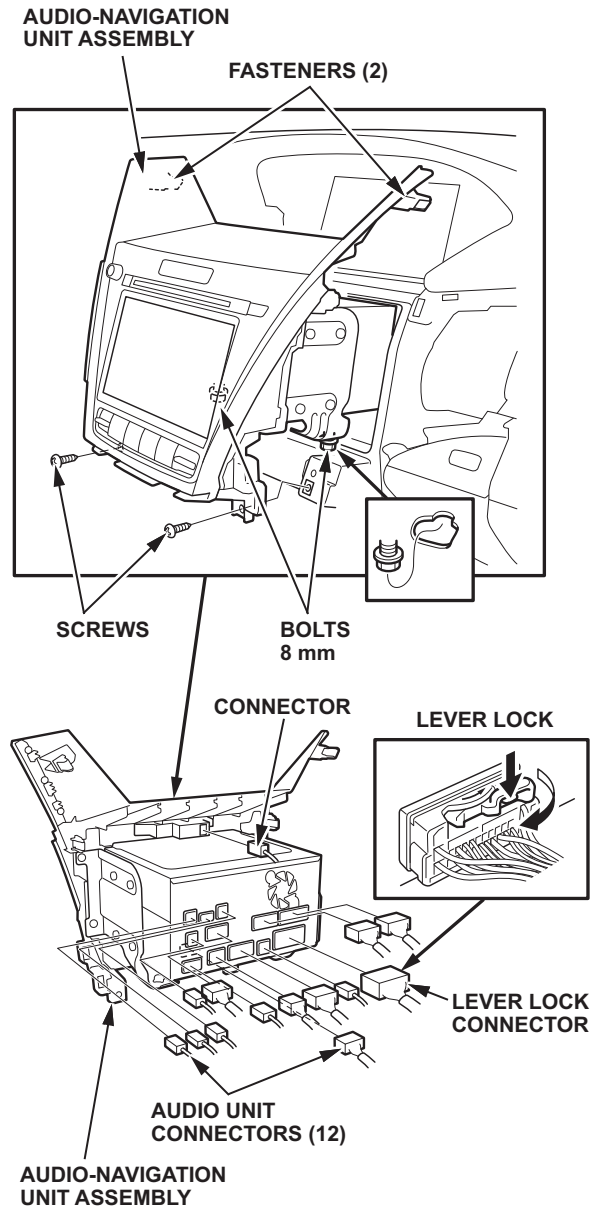

8. Remove the center display visor.

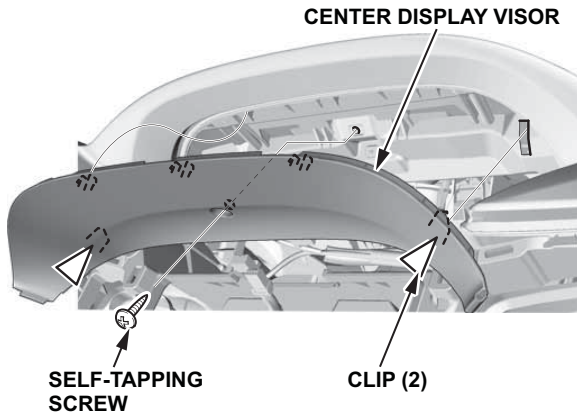

9. Remove the center display unit. Release the clips using the plastic trim tool and rotate the bottom of the display up slightly while pulling away from the opening.

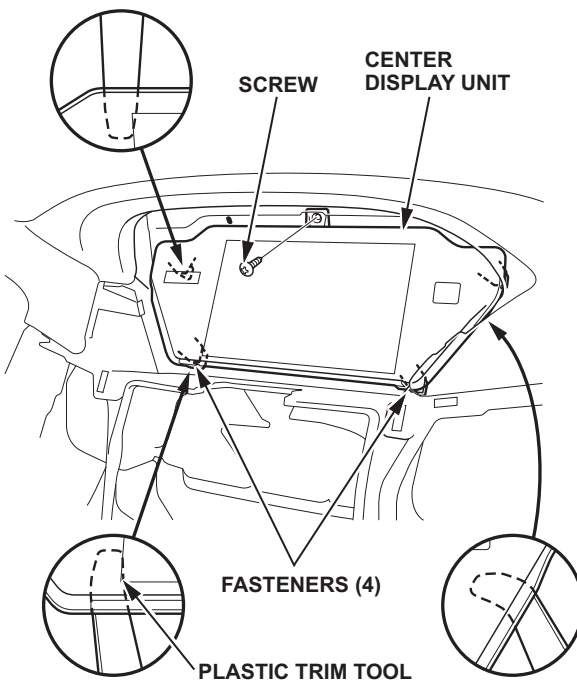

- Disconnect the center display unit connectors.

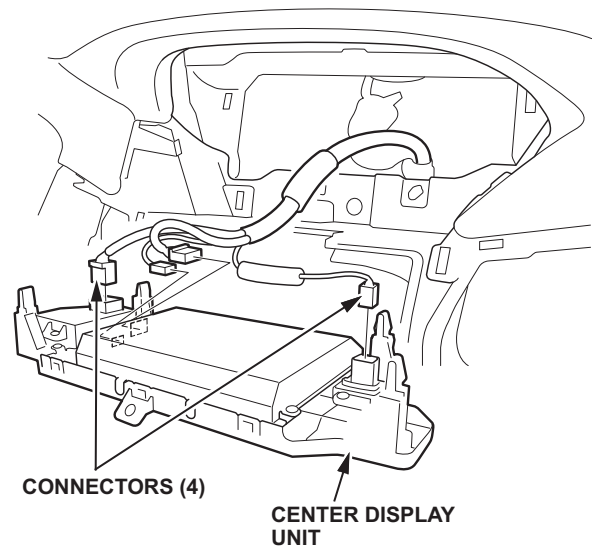

10. Locate the green 2-way transceiver connector secured to the vehicle harness. Remove the green tape to free the connector from the vehicle harness.

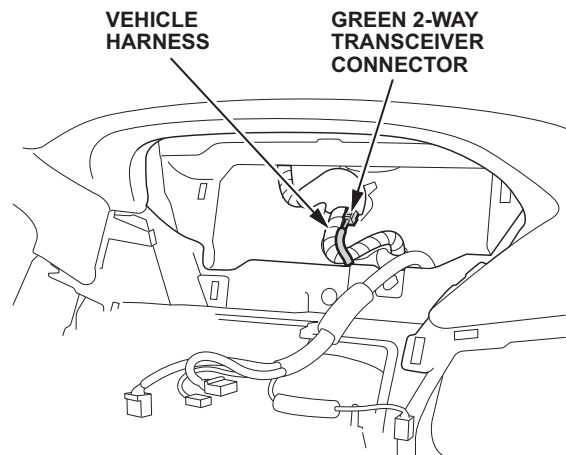

11. Slide the transceiver on the antenna bracket as shown.

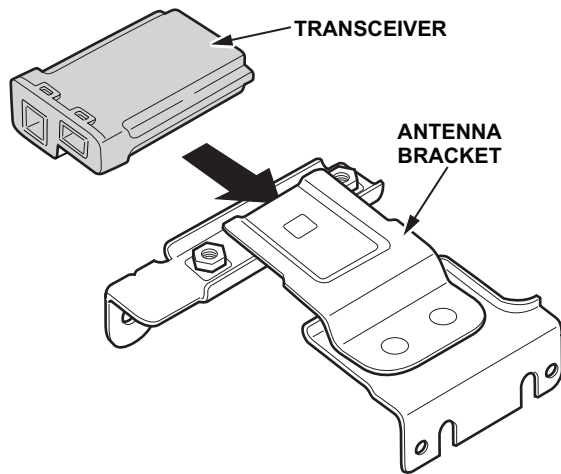

12. Attach the bidirectional antenna to the bracket using the two screws as shown.

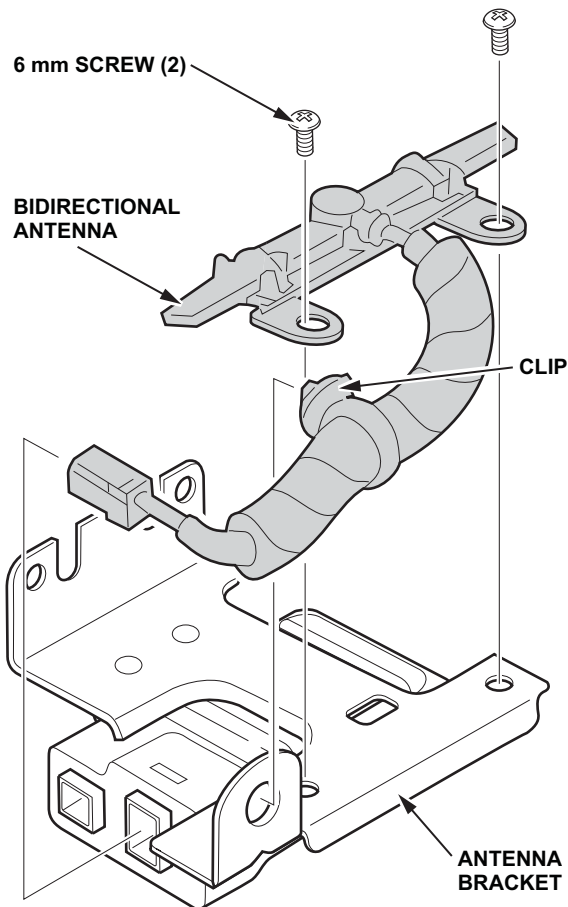

13. Plug the bidirectional antenna into the transceiver and secure the clip on the harness to the bracket.

14. Locate the mounting point on the vehicle and attach the antenna bracket assembly using the two self-tapping screws.

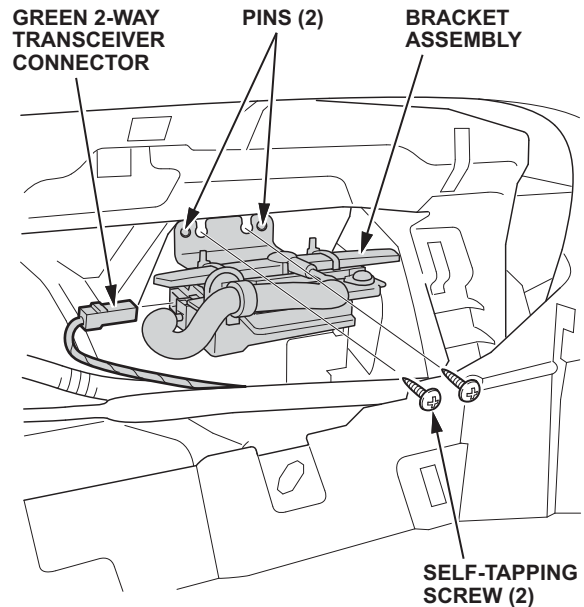

15. Plug in the green 2-way transceiver connector to the transceiver unit.
16. Check that all wire harnesses are routed properly and all connectors are plugged in.
17. Reinstall all removed parts.
18. Reconnect the negative cable to the battery.
19. Press and hold the audio unit power button for two seconds to restore the audio system and navi system (if equipped) functions.
20. Reset the clock.
21. Refer to the Owner's Manual for the remote operation.

## **ENGINE REMOTE START SYSTEM REGISTRATION**

NOTE: the PCM code will be required for this procedure.

1. Connect the HDS to the data link connector.
2. From the System Selection Menu, select ONE-PUSH START, then go to Registration.
3. From the Registration Menu, select KEYLESS ACCESS Remotes, then select 2-WAY KEYLESS SETUP. Change the setting to 2-WAY KEYLESS mode and follow the HDS prompts.
4. Go back to the KEYLESS ACCESS Remotes Registration Menu, select Add a KEYLESS ACCESS Remote, and follow the instructions on the HDS screen. Do not bring the Remote Starter remote into the vehicle until the HDS asks for the new remote.
5. Repeat step 4 for the second Remote Starter remote.
6. After registration, verify all remote-related systems work normally with all remotes.

## **REMOTE ENGINE START**

1. Press LOCK, then press and hold ENGINE. The amber LED blinks, and the green LED stays solid for one second when the engine starts. You can repeat this once at any time within 10 minutes of the initial remote start for a 10-minute extension.
2. While remote engine start is on:
  - The climate control system can warm or cool the interior, depending on the ambient temperature.
  - The security system remains on.
  - Exterior lights and accessories remain off.
3. To start driving after you enter the vehicle, depress the brake pedal and press ENGINE/START/STOP.

## **STOPPING THE ENGINE**

Press and hold ENGINE. The red LED stays solid for one second.

NOTE: The engine will stop if it has been running for more than 10 minutes or any door is opened without using the remote or keyless access.

For additional technical information, refer to the vehicle owner's manual.